

**PLANTA**  
ESCALA 1:75

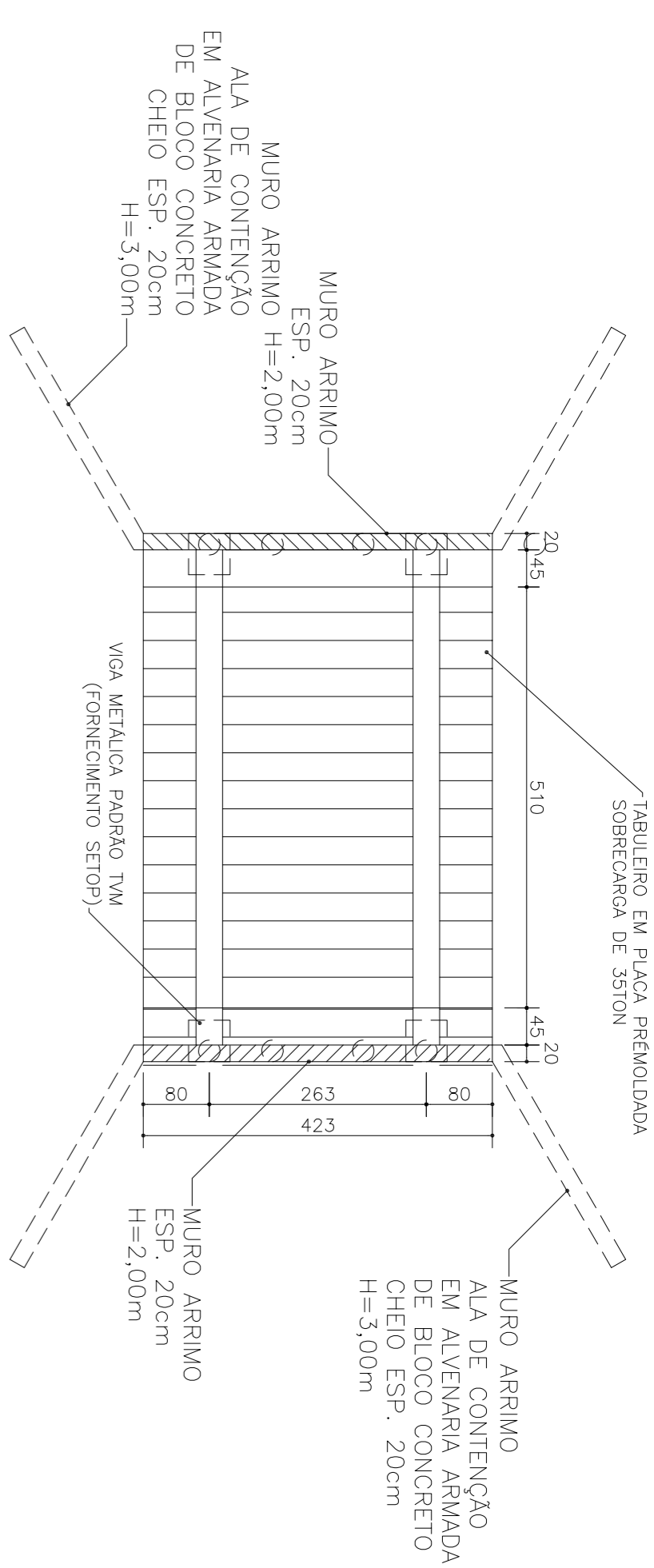

**PLANTA DE FÔRMA**  
ESCALA 1:75

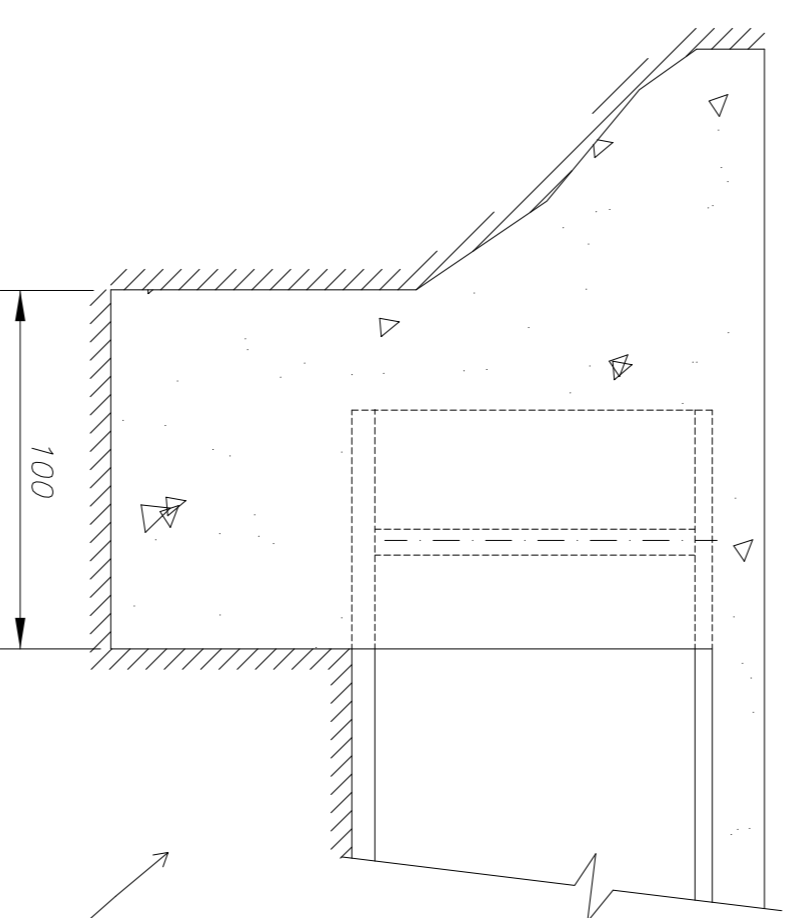

**DETALHE DO ENCONTRO**  
VIGAS METÁLICAS NAS  
CABEÇAS DE CONCRETO

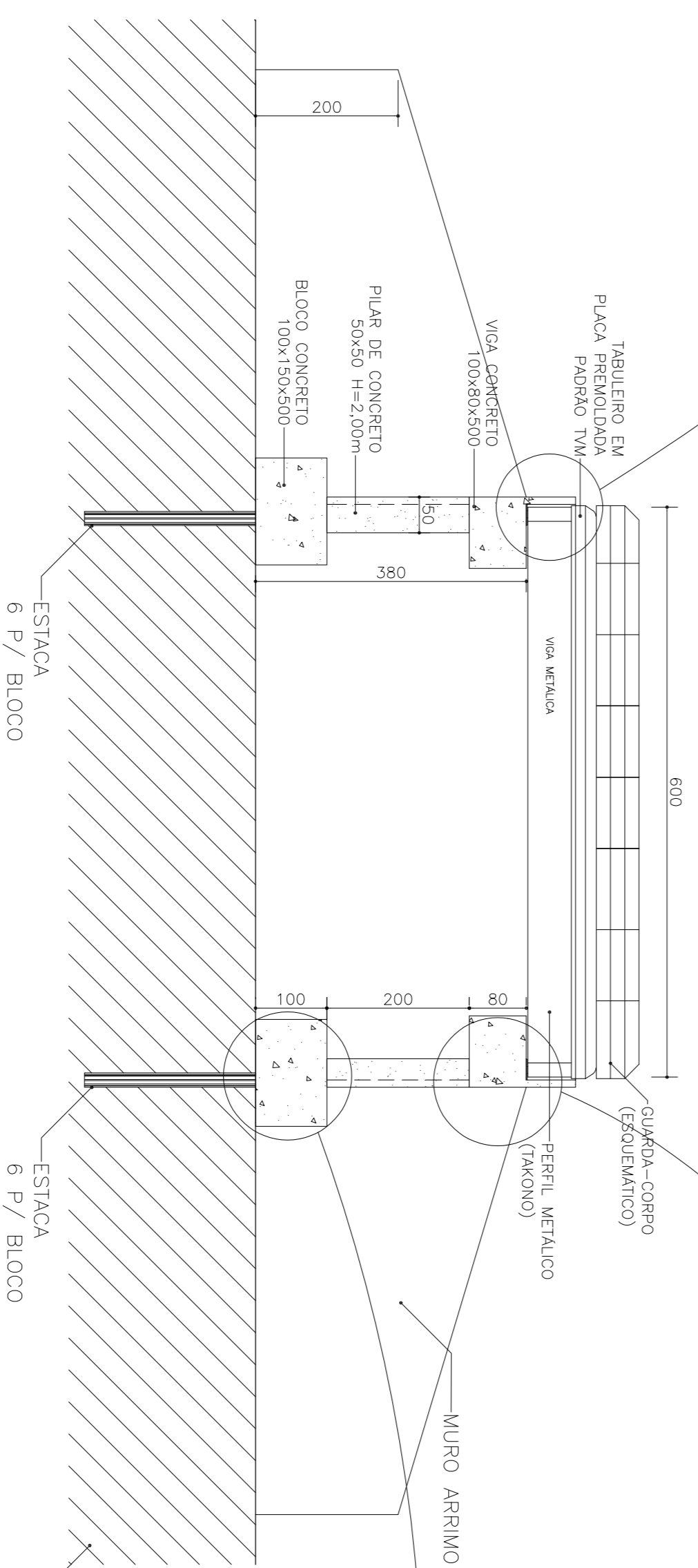

**CORTE AA**  
ESCALA 1:50

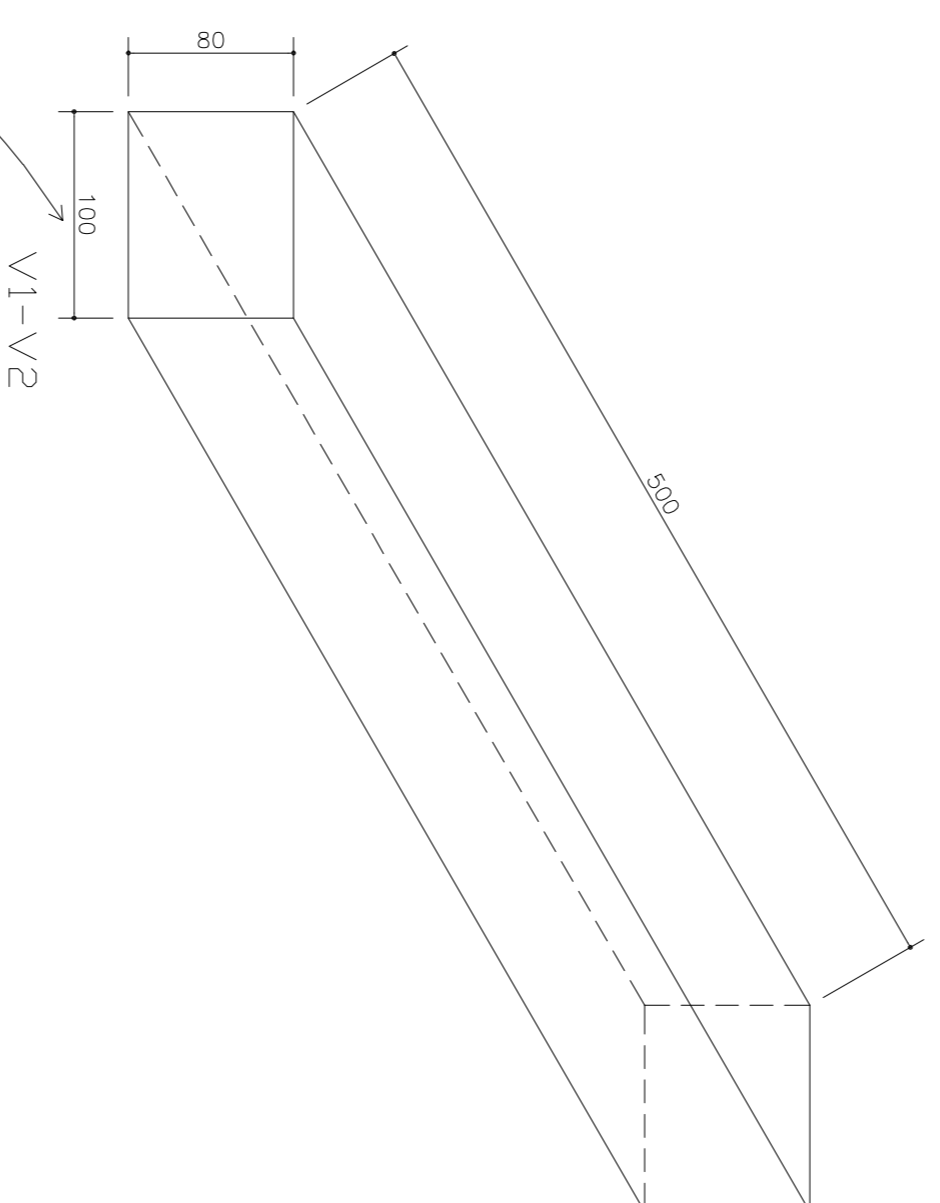

**CORTE BB**  
ESCALA 1:75

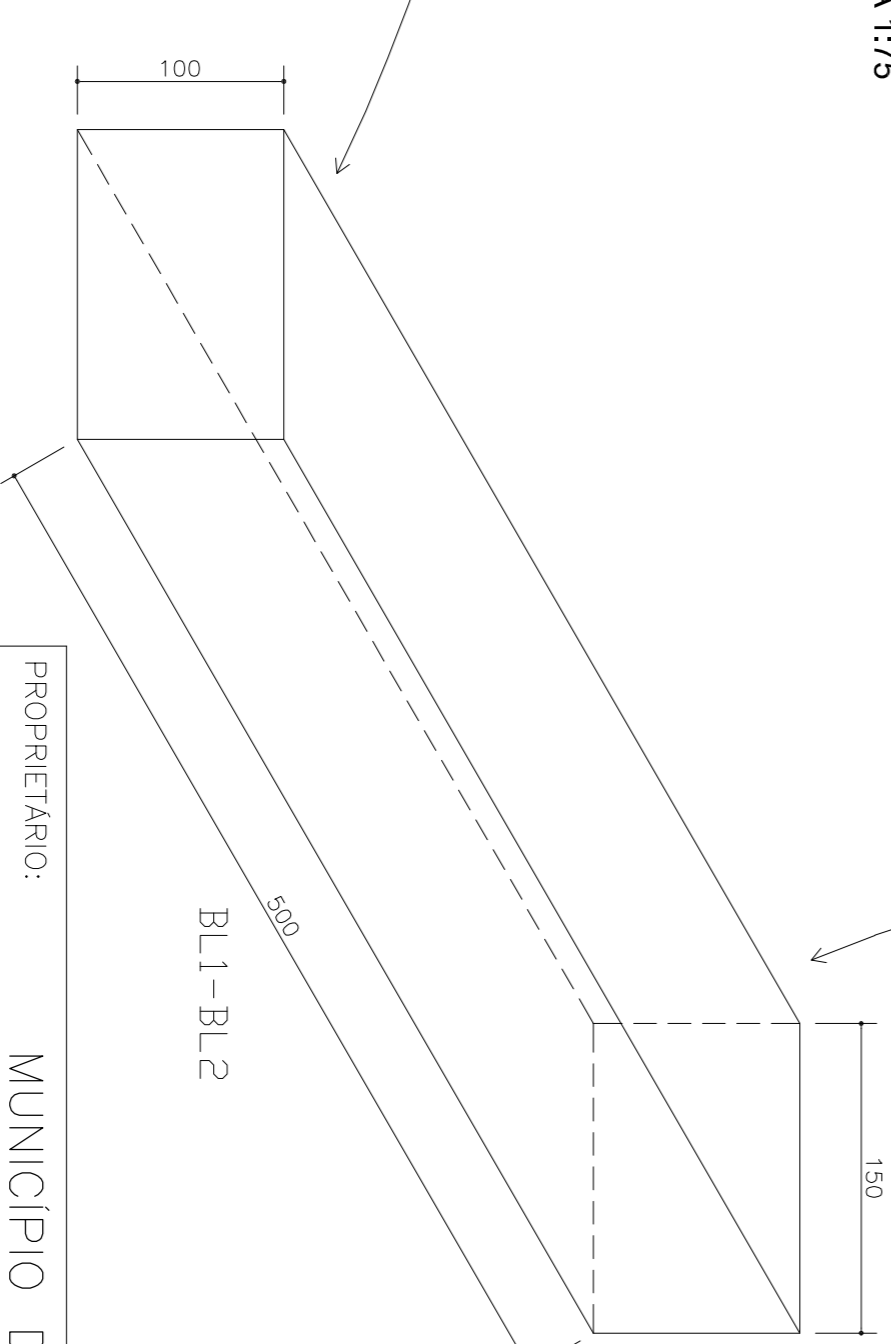

**CORTE AA**  
ESCALA 1:50

PROPRIETÁRIO: MUNICÍPIO DE PASSABEM  
PONTA MACHADOS  
ADM: 2017-2020

RESPONSÁVEL TÉCNICO: WEBERT ROBISON RIBEIRO

PROJETO

USO: PÚBLICO

TÍTULO: PONTE ESTRUTURA DE CONCRETO

ENDEREÇO: COORDENADAS: 19°19'59.96"S , 43°10'48.12"W

FOLHA: 01/01

ARQ: